

NOTE: DUE TO SPACE RESTRAINTS, NOT ALL TOWN ROAD NAMES APPEAR ON THIS INDEX MAP. THE FOLLOWING IS A LIST OF THESE STREETS:

- 1) AMO ST. 224.045, 224.046
- 2) BACKUS ST. 224.038
- 3) CATHERINE ST. 224.030, 224.038
- 4) DESSNA DR. 224.046
- 5) CHERRY HILL RD. 223.036
- 6) CHURCH ST. 201.036, 202.029
- 7) COLBY ST. 224.037, 224.045
- 8) EDDY RD. 225.057, 225.065
- 9) FIFTH ST. 225.071
- 10) FIRE RD. 202.000, 202.029
- 11) FIRST ST. 225.072
- 12) FOREST VIEW RD. 224.046
- 13) FOURTH ST. 225.071, 225.072
- 14) FRONT ST. 225.072
- 15) GORE ST. 223.000, 223.036, 224.029
- 16) GREGG ST. 224.045
- 17) GRIFFIN AV. 224.038, 224.046
- 18) HALL AV. 224.021, 224.029
- 19) HAMELE ST. 225.072
- 20) HANKS RD. 223.044
- 21) HANSON ST. 202.000, 202.029
- 22) KENNY ST. 224.028
- 23) KERR ST. 224.038, 224.046
- 24) MARSHALL AV. 224.030
- 25) MORAWK DR. 224.046
- 26) OLD RT. 3/FINE 202.000
- 27) OLD S.H. 58 201.002
- 28) POTTER AV. 224.029, 224.030
- 29) PLUMMERVILLE RD.(PVT. RD.) 223.010
- 30) REIMER RD. 224.045, 224.037
- 31) RIVER ST. 225.071, 225.072
- 32) RIVER RD. 213.051
- 33) SCHOOL ST. 224.029
- 34) SCOTT'S POINT RD. 224.029, 224.030
- 35) SECOND ST. 225.072
- 36) SHELTON CREST RD. 224.030, 224.038
- 37) SIXTH ST. 225.071
- 38) SPRING ST. 202.029
- 39) SWISS POINT RD. 223.036
- 40) THIRD ST. 225.072
- 41) VALLEY VIEW DR. 224.046

THIS IS A SUPPLEMENTAL LIST OF TOWN ROADS.

- 1) BENSON MINES GOLF COURSE RD. 224.030
- 2) COLTON LN. 224.038
- 3) MAIN ST. 225.000, 225.071
- 4) MILL RD. 213.051
- 5) FINE ST. 224.038

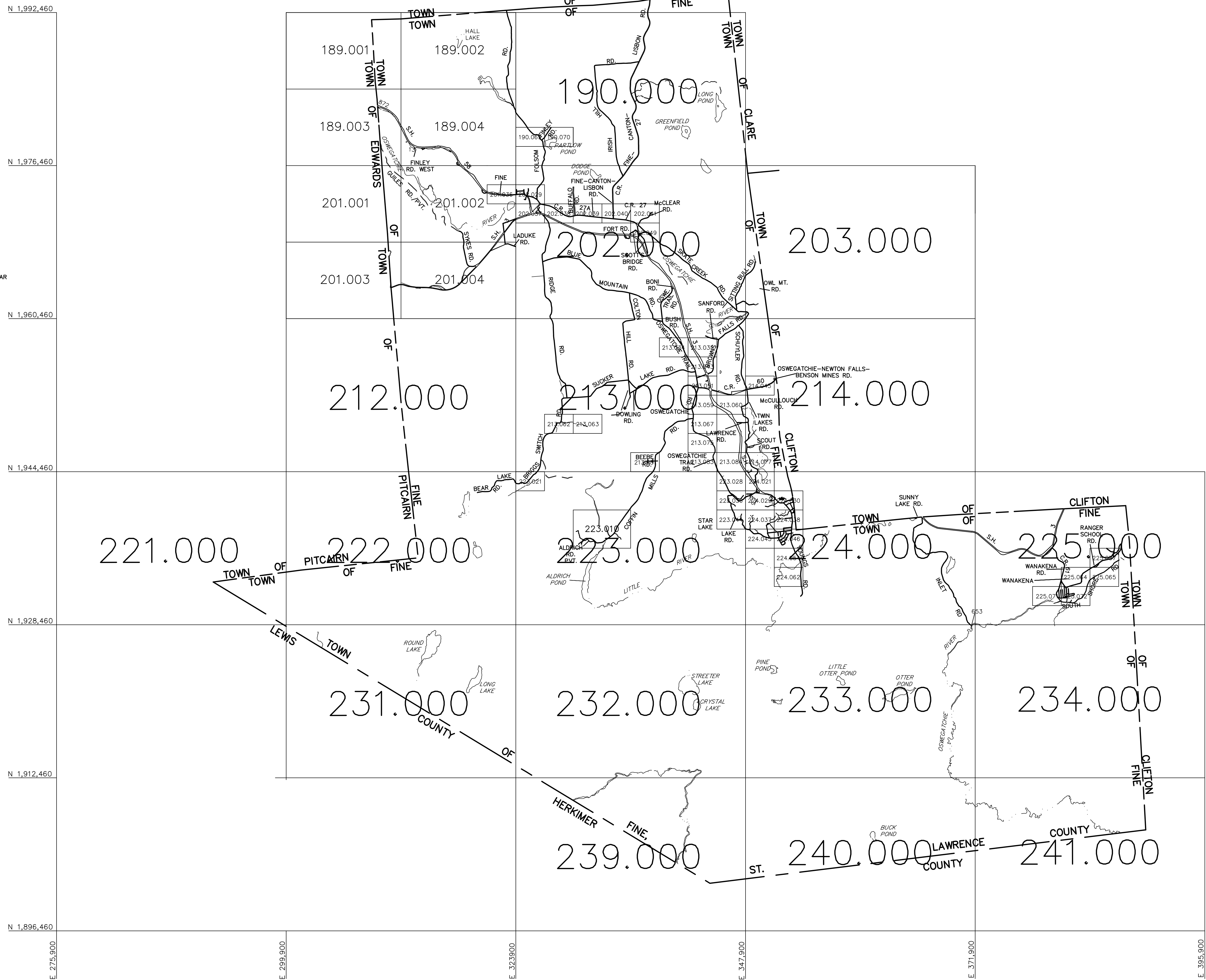

THIS MAP WAS PREPARED FOR TAX PURPOSES ONLY
NOT TO BE USED FOR CONVEYANCE

<p>NOTICE OF DISCLAIMER</p> <p>This map represents a compilation of graphical and textual information from deeds and surveys, a planimetric base map, and digital conversions of hand drawn maps. Errors and omissions can occur from each of these sources; each source represents a large number of records and originators of information. As a practical matter, the County does not warrant the accuracy or completeness of the information portrayed. The end user of these maps agrees to accept the data "as is" with the full knowledge that errors and omissions may exist, and to hold harmless the County for any damages that may result from an inappropriate use of these maps.</p>	<p>DRAWING LEGEND</p> <table style="width: 100%; border-collapse: collapse;"> <tr> <td style="width: 30%;">International Boundary</td> <td style="width: 30%;"></td> <td style="width: 30%;">Denotes Common Owner</td> <td style="width: 10%;"></td> </tr> <tr> <td>County Boundary</td> <td></td> <td>Railroad</td> <td></td> </tr> <tr> <td>Town Boundary</td> <td></td> <td>Water</td> <td></td> </tr> <tr> <td>Village Boundary</td> <td></td> <td>Block Limit Line</td> <td></td> </tr> <tr> <td>Property or R/W Line</td> <td></td> <td>Special District Line</td> <td></td> </tr> <tr> <td></td> <td></td> <td>Subdivision Lot Line</td> <td></td> </tr> </table>	International Boundary		Denotes Common Owner		County Boundary		Railroad		Town Boundary		Water		Village Boundary		Block Limit Line		Property or R/W Line		Special District Line				Subdivision Lot Line		<table style="width: 100%; border-collapse: collapse;"> <tr> <td style="width: 30%;">Block No.</td> <td style="width: 10%; text-align: center;">①</td> <td style="width: 60%;"></td> </tr> <tr> <td>Parcel No.</td> <td style="text-align: center;">27</td> <td></td> </tr> <tr> <td>Subdivision Lot No.</td> <td style="text-align: center;">(10)</td> <td></td> </tr> <tr> <td>Deed Dimension</td> <td style="text-align: center;">112'</td> <td></td> </tr> <tr> <td>Scaled Dimension</td> <td style="text-align: center;">27.8'</td> <td></td> </tr> <tr> <td>Deed Area</td> <td style="text-align: center;">(27.33)</td> <td></td> </tr> <tr> <td>Calculated Area</td> <td style="text-align: center;">148.2A(c)</td> <td></td> </tr> </table>	Block No.	①		Parcel No.	27		Subdivision Lot No.	(10)		Deed Dimension	112'		Scaled Dimension	27.8'		Deed Area	(27.33)		Calculated Area	148.2A(c)		<p>ST. LAWRENCE COUNTY NEW YORK REAL PROPERTY COUNTY OFFICE BUILDING CANTON, NEW YORK 13617 (315) 379-2272 OFFICE (315) 229-3222 FAX</p>	<p>GRAPHIC SCALE</p> <p>(IN FEET) 1 inch = 5000ft.</p>	<table border="1" style="width: 100%; border-collapse: collapse;"> <tr><td style="text-align: center;">7</td><td></td><td></td><td></td></tr> <tr><td style="text-align: center;">6</td><td></td><td></td><td></td></tr> <tr><td style="text-align: center;">5</td><td></td><td></td><td></td></tr> <tr><td style="text-align: center;">4</td><td></td><td></td><td></td></tr> <tr><td style="text-align: center;">3</td><td></td><td></td><td></td></tr> <tr><td style="text-align: center;">2</td><td></td><td></td><td></td></tr> <tr><td style="text-align: center;">1</td><td></td><td></td><td></td></tr> <tr><td colspan="2" style="text-align: center;">REVISIONS</td><td style="text-align: center;">DATE</td><td style="text-align: center;">BY</td></tr> </table>	7				6				5				4				3				2				1				REVISIONS		DATE	BY	<p>KEY MAP</p>	<table border="1" style="width: 100%; border-collapse: collapse;"> <tr> <td style="width: 50%;">TOWN OF: FINE</td> <td style="width: 50%;">SECTION NO.</td> </tr> <tr> <td>DISTRICT NO.: 403600</td> <td style="text-align: center; font-size: 2em; font-weight: bold;">INDEX</td> </tr> <tr> <td>Date of Conversion: 02/23/2010 JIM</td> <td style="text-align: center;">PROPERTY MAP</td> </tr> </table>	TOWN OF: FINE	SECTION NO.	DISTRICT NO.: 403600	INDEX	Date of Conversion: 02/23/2010 JIM	PROPERTY MAP
International Boundary		Denotes Common Owner																																																																																								
County Boundary		Railroad																																																																																								
Town Boundary		Water																																																																																								
Village Boundary		Block Limit Line																																																																																								
Property or R/W Line		Special District Line																																																																																								
		Subdivision Lot Line																																																																																								
Block No.	①																																																																																									
Parcel No.	27																																																																																									
Subdivision Lot No.	(10)																																																																																									
Deed Dimension	112'																																																																																									
Scaled Dimension	27.8'																																																																																									
Deed Area	(27.33)																																																																																									
Calculated Area	148.2A(c)																																																																																									
7																																																																																										
6																																																																																										
5																																																																																										
4																																																																																										
3																																																																																										
2																																																																																										
1																																																																																										
REVISIONS		DATE	BY																																																																																							
TOWN OF: FINE	SECTION NO.																																																																																									
DISTRICT NO.: 403600	INDEX																																																																																									
Date of Conversion: 02/23/2010 JIM	PROPERTY MAP																																																																																									