

N 1,992,460

N 1,976,460

N 1,960,460

N 1,944,460

N 1,928,460

N 1,912,460

N 1,896,460

E 275,900

E 299,900

E 323,900

E 347,900

E 371,900

E 395,900

NOTE: DUE TO SPACE RESTRAINTS, NOT ALL TOWN ROAD NAMES APPEAR ON THIS INDEX MAP. THE FOLLOWING IS A LIST OF THESE STREETS.

- 1) AMO ST. 224.045, 224.046
- 2) BACKUS ST. 224.038
- 3) CATHERINE ST. 224.030, 224.038
- 4) CESSNA DR. 224.046
- 5) CHERRY HILL RD. 223.036
- 6) CHURCH ST. 201.036, 202.029
- 7) COLBY ST. 224.037, 224.045
- 8) EDDY RD. 225.057, 225.065
- 9) FIFTH ST. 225.071
- 10) FIRE RD. 202.000, 202.029
- 11) FIRST ST. 225.072
- 12) FOREST VIEW RD. 224.046
- 13) FOURTH ST. 225.071, 225.072
- 14) FRONT ST. 225.072
- 15) GORE ST. 223.000, 223.036, 224.029
- 16) GREGG ST. 224.045
- 17) GRIFFIN AV. 224.038, 224.046
- 18) HALL AV. 224.021, 224.029
- 19) HAMELE ST. 225.072
- 20) HANKS RD. 223.044
- 21) HANSON ST. 202.000, 202.029
- 22) KENNY ST. 224.026
- 23) KERR ST. 224.038, 224.046
- 24) MARSHALL AV. 224.030
- 25) MOHAWK DR. 224.046
- 26) OLD RT. 3/FINE 202.000
- 27) OLD S.H. 58 201.002
- 28) POTTER AV. 224.029, 224.030
- 29) PLUMMERVILLE RD.(PVT. RD.) 223.010
- 30) REIMER RD. 224.045, 224.037
- 31) RIVER ST. 225.071, 225.072
- 32) RIVER RD. 213.051
- 33) SCHOOL ST. 224.029
- 34) SCOTT'S POINT RD. 224.029, 224.030
- 35) SECOND ST. 225.072
- 36) SHELTON CREST RD. 224.030, 224.038
- 37) SIXTH ST. 225.071
- 38) SPRING ST. 202.029
- 39) SWISS POINT RD. 223.036
- 40) THIRD ST. 225.072
- 41) VALLEY VIEW DR. 224.046

THIS IS A SUPPLEMENTAL LIST OF TOWN ROADS.

- 1) BENSON MINES GOLF COURSE RD. 224.030
- 2) CLIFTON LN. 224.038
- 3) MAIN ST. 225.000, 225.071
- 4) MILL RD. 213.051
- 5) PINE ST. 224.038

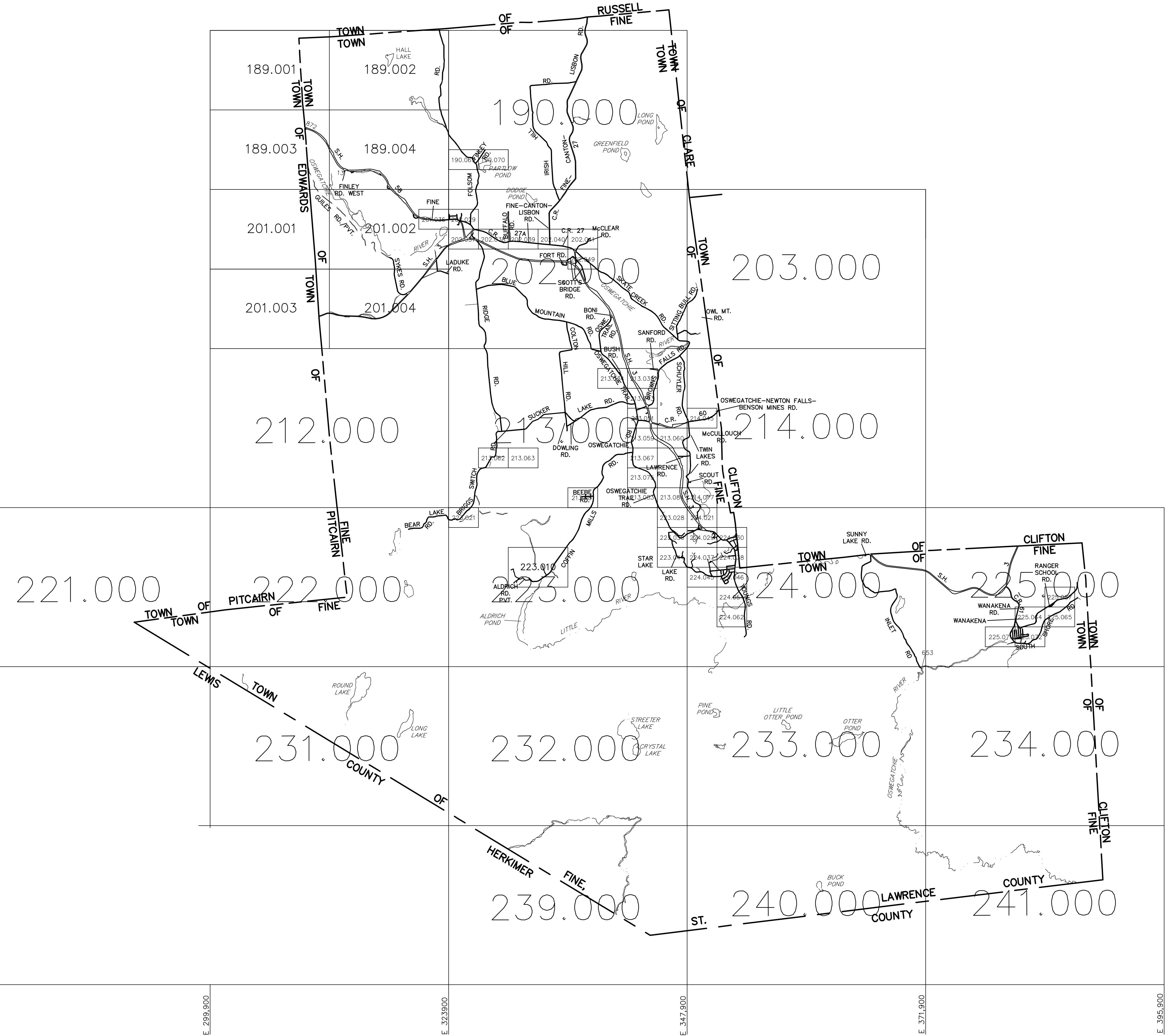

THIS MAP WAS PREPARED FOR TAX PURPOSES ONLY
NOT TO BE USED FOR CONVEYANCE

<p>NOTICE OF DISCLAIMER</p> <p>This map represents a compilation of graphical and textual information from deeds and surveys, a planimetric base map, and digital conversions of hand drawn mylar maps. Errors and omissions can occur from each of these sources; each source represents a large number of records and originators of information. As a practical matter, the County does not warrant the accuracy or completeness of the information portrayed. The end user of these maps agrees to accept the data "as is" with the full knowledge that errors and omissions may exist, and to hold harmless the County for any damages that may result from an inappropriate use of these maps.</p>	<p>DRAWING LEGEND</p> <table style="width: 100%; border-collapse: collapse;"> <tr> <td style="width: 33%;">International Boundary</td> <td style="width: 33%;">Denotes Common Owner</td> <td style="width: 33%;">Block No.</td> </tr> <tr> <td>County Boundary</td> <td>Railroad</td> <td>Parcel No.</td> </tr> <tr> <td>Town Boundary</td> <td>Water</td> <td>Subdivision Lot No.</td> </tr> <tr> <td>Village Boundary</td> <td>Block Limit Line</td> <td>Deed Dimension</td> </tr> <tr> <td>Property or R/W Line</td> <td>Special District Line</td> <td>Scaled Dimension</td> </tr> <tr> <td></td> <td>Subdivision Lot Line</td> <td>Deed Area</td> </tr> <tr> <td></td> <td></td> <td>Calculated Area</td> </tr> </table>	International Boundary	Denotes Common Owner	Block No.	County Boundary	Railroad	Parcel No.	Town Boundary	Water	Subdivision Lot No.	Village Boundary	Block Limit Line	Deed Dimension	Property or R/W Line	Special District Line	Scaled Dimension		Subdivision Lot Line	Deed Area			Calculated Area	<p>ST. LAWRENCE COUNTY NEW YORK REAL PROPERTY COUNTY OFFICE BUILDING CANTON, NEW YORK 13617 (315) 379-2272 OFFICE (315) 223-3222 FAX</p>	<p>GRAPHIC SCALE</p> <p>(IN FEET) 1 inch = 5000ft.</p>	<table border="1" style="width: 100%; border-collapse: collapse;"> <tr><td>7</td><td></td><td></td><td></td></tr> <tr><td>6</td><td></td><td></td><td></td></tr> <tr><td>5</td><td></td><td></td><td></td></tr> <tr><td>4</td><td></td><td></td><td></td></tr> <tr><td>3</td><td></td><td></td><td></td></tr> <tr><td>2</td><td></td><td></td><td></td></tr> <tr><td>1</td><td></td><td></td><td></td></tr> </table> <p>REVISIONS DATE BY</p>	7				6				5				4				3				2				1				<p>KEY MAP</p> <p>YOU ARE HERE</p>	<p>TOWN OF: FINE</p> <p>DISTRICT NO.: 403600</p> <p>Date of Conversion: 02/23/2010 JM</p>	<p>SECTION NO.</p> <p style="font-size: 2em; text-align: center;">INDEX</p> <p>PROPERTY MAP</p>
International Boundary	Denotes Common Owner	Block No.																																																						
County Boundary	Railroad	Parcel No.																																																						
Town Boundary	Water	Subdivision Lot No.																																																						
Village Boundary	Block Limit Line	Deed Dimension																																																						
Property or R/W Line	Special District Line	Scaled Dimension																																																						
	Subdivision Lot Line	Deed Area																																																						
		Calculated Area																																																						
7																																																								
6																																																								
5																																																								
4																																																								
3																																																								
2																																																								
1																																																								